

Property Owner-Initiated Consideration Areas

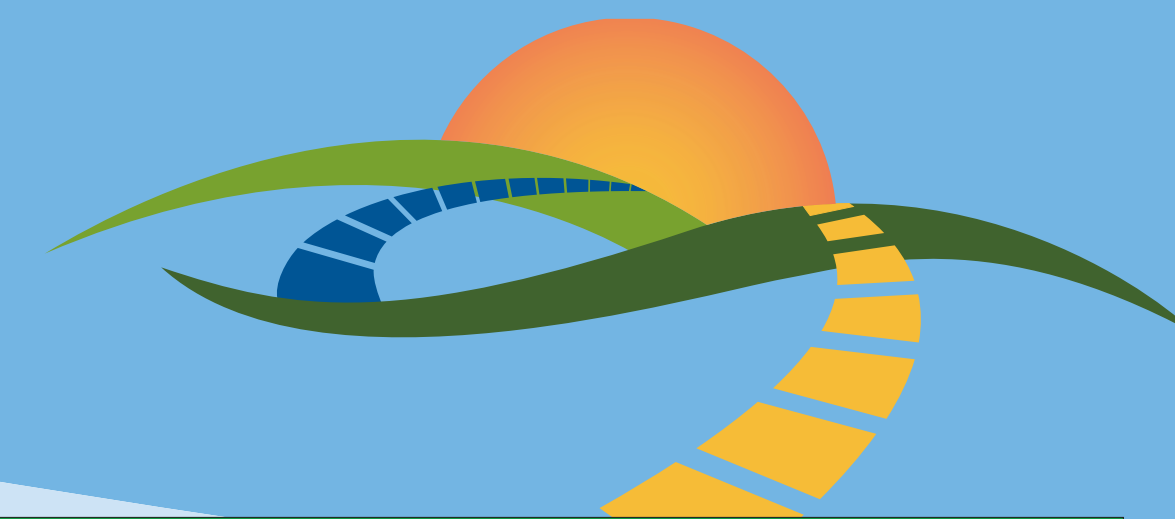

P.O. #39

Existing GP Land Use

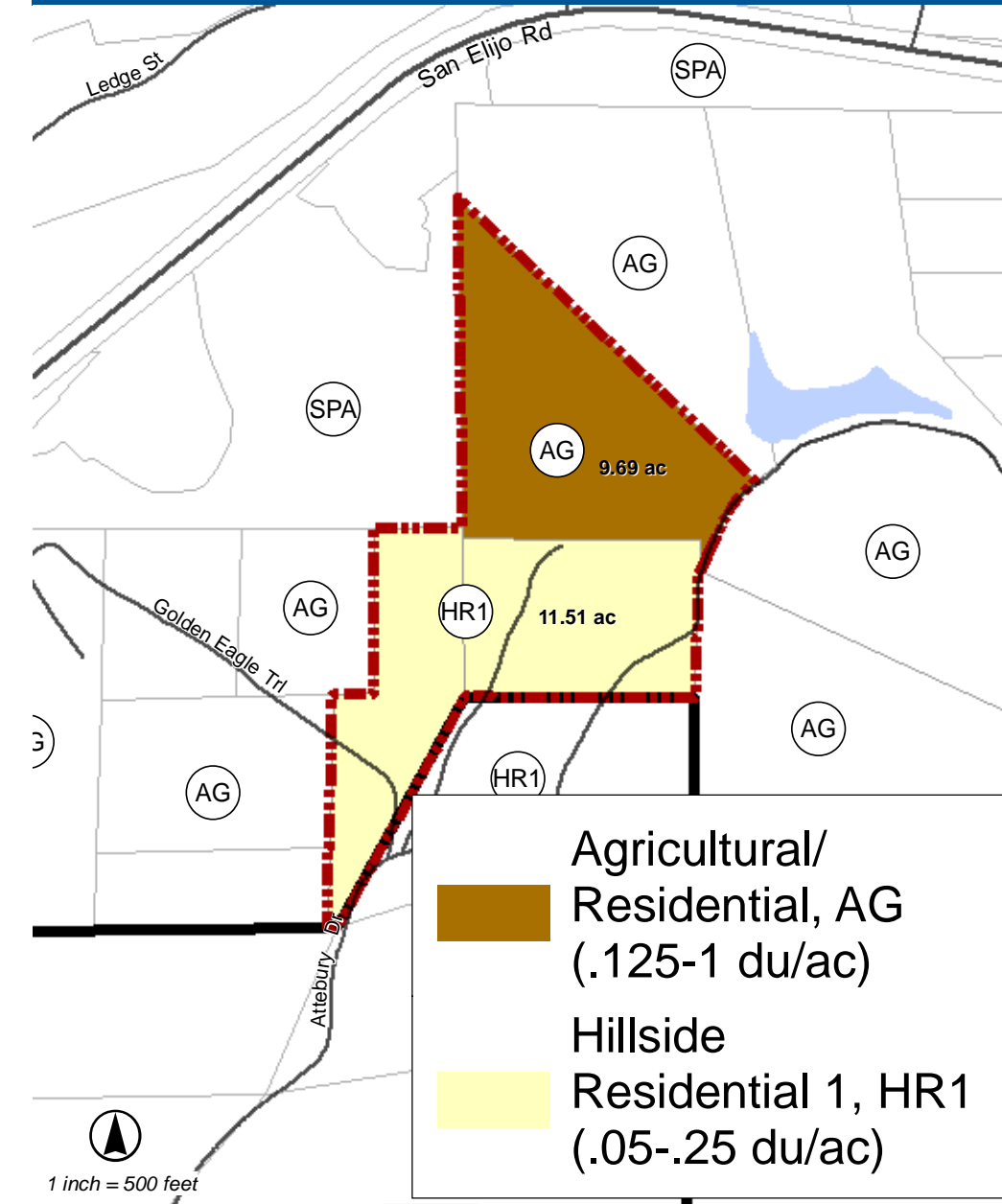

Existing General Plan Land Use:
Agricultural/Residential (AG .125-1 du/ac)(1-8 acres per dwelling unit) and Hillside Residential (HR1 .05-.25 du/ac)(4-20 acres per dwelling unit)

GPAC Recommended Land Use

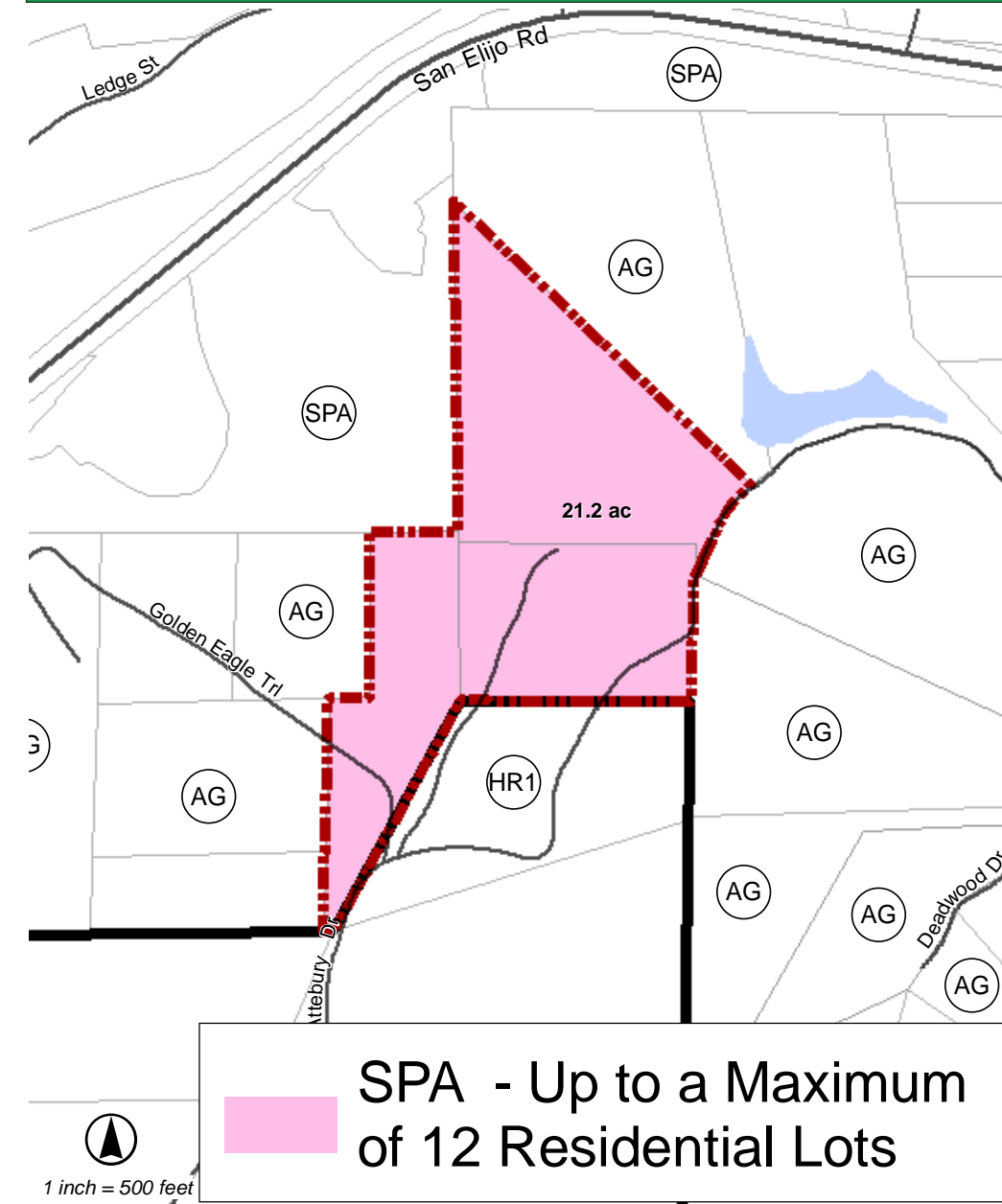

GPAC Recommended Land Use:
Specific Plan Area - Up to a maximum of 12 residential lots

P.O. #40

Existing GP Land Use

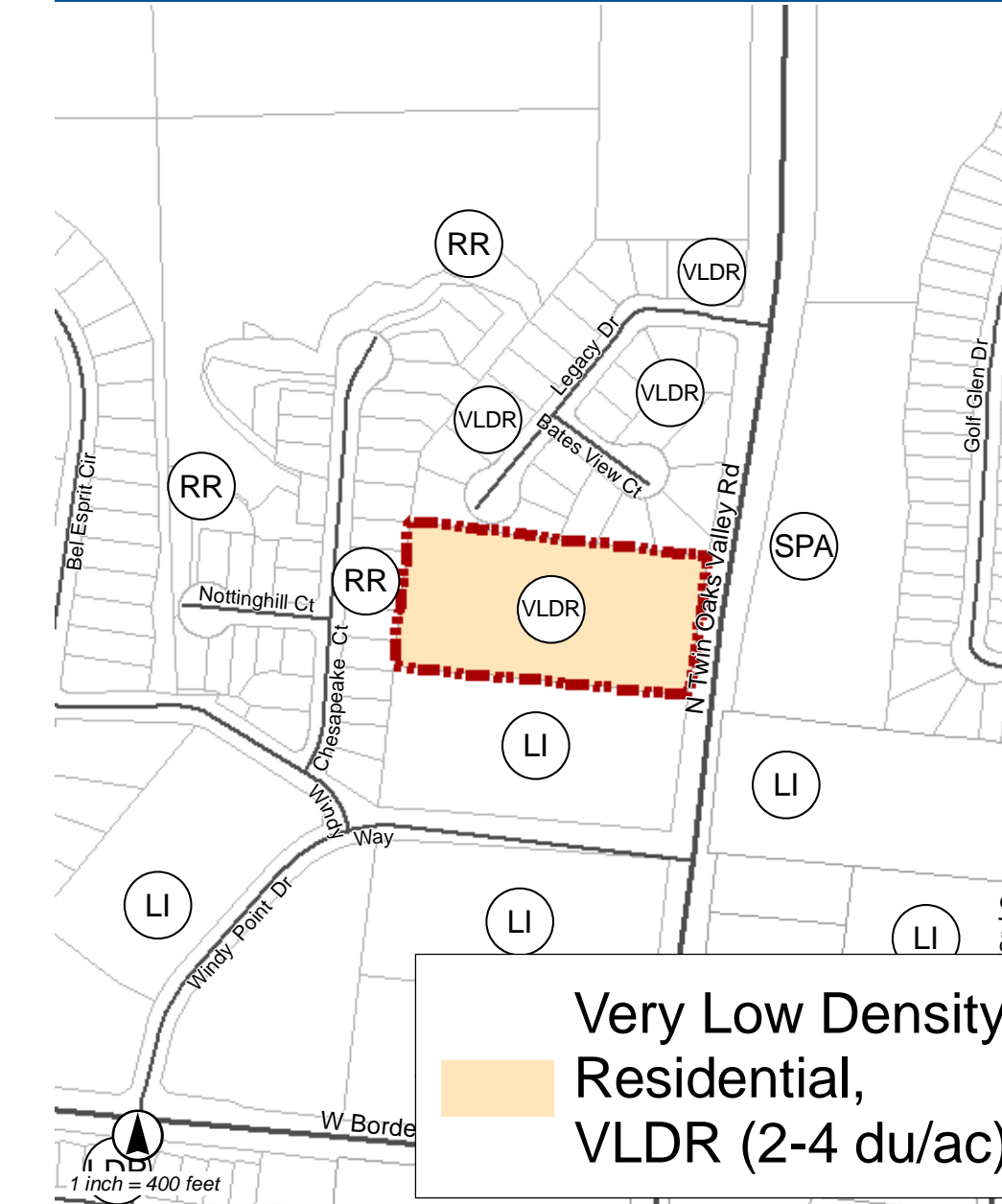

Existing General Plan Land Use:
Very Low Density Residential (VLDR 2-4 du/ac)

GPAC Recommended Land Use

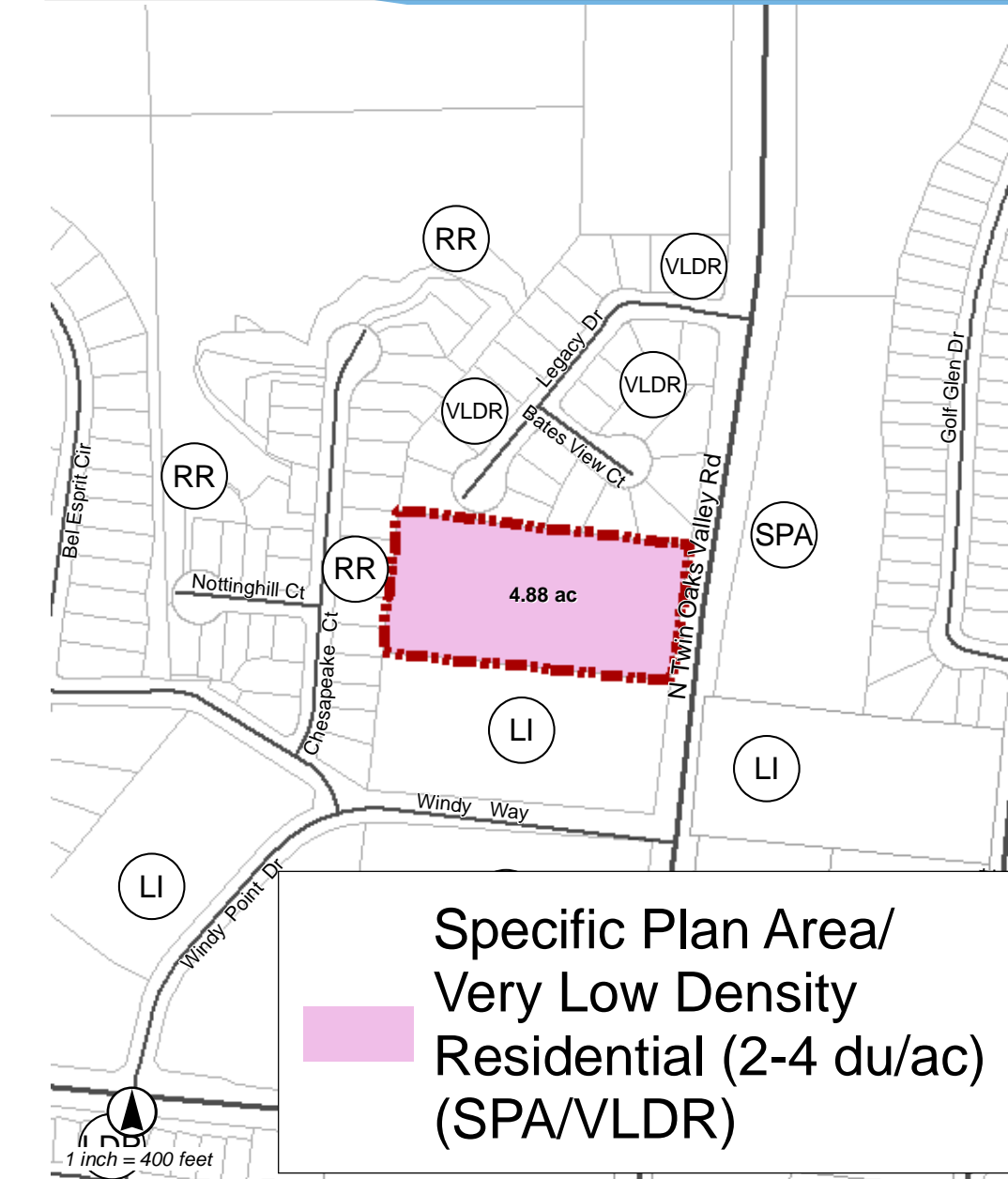

GPAC Recommended Land Use:
Specific Plan Area/Very Low Density Residential (2-4 du/ac)(SPA/VLDR)

P.O. #41

Existing GP Land Use



Existing General Plan Land Use:
Light Industrial (LI)

GPAC Recommended Land Use



GPAC Recommended Land Use:
Specific Plan Area/Industrial (SPA/I)

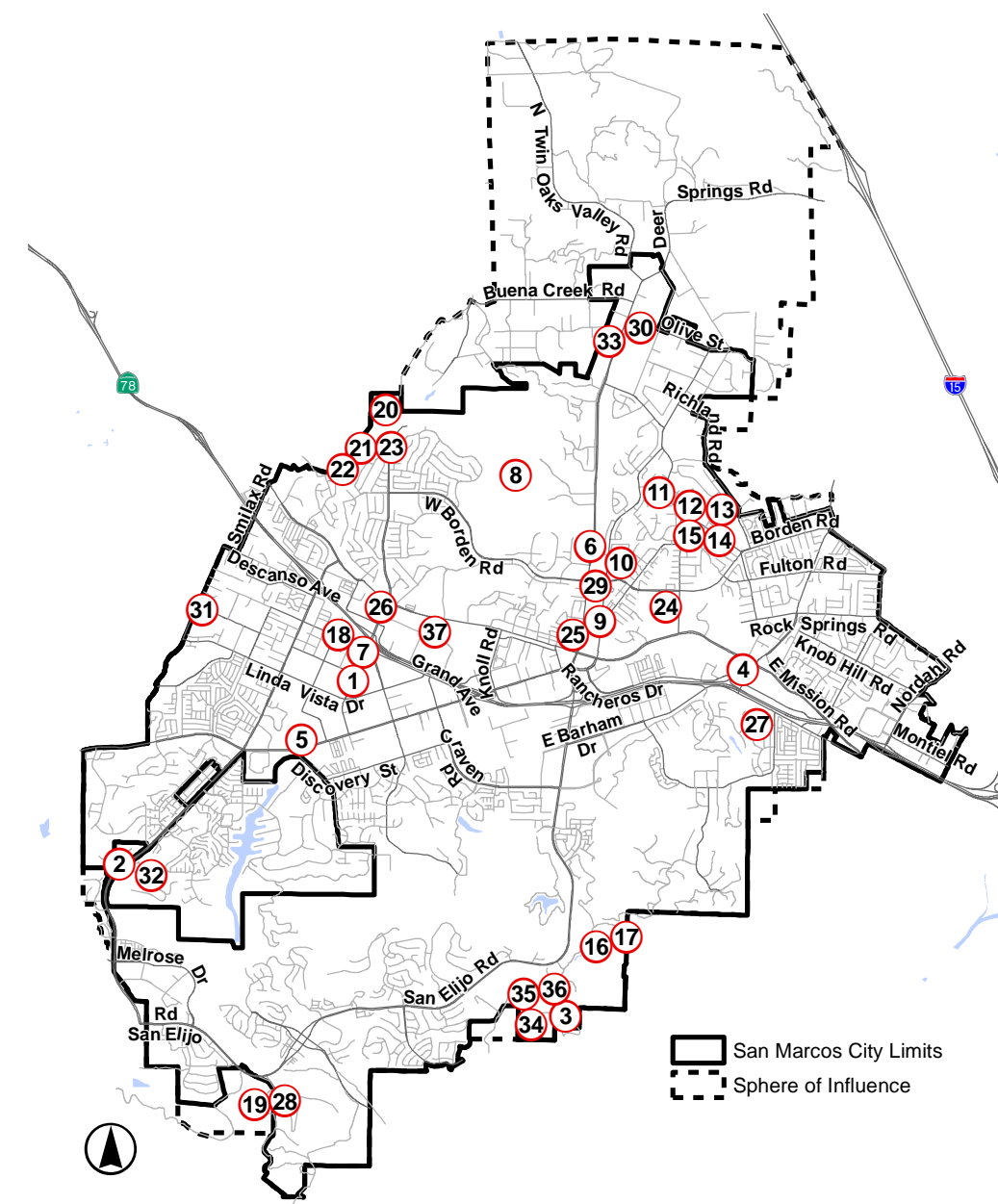

Land Use Code	Land Use Description
(AG)	Denotes Existing General Plan land use designation
AG	Agricultural/Residential (.125-1 du/ac)
AI	Artisan Industrial Overlay
BP	Business Park
C	Commercial
COUNTY RR	County Rural Residential (.125-1 du/ac)
HDR	High Density Residential (30-45 du/ac)
HR1	Hillside Residential 1 (.05-.25 du/ac)
HR2	Hillside Residential 2 (.25-.50 du/ac)
I	Industrial
LDR	Low Density Residential (4-8 du/ac)
LI	Light Industrial
LMDR	Low Medium Density Residential (8-12 du/ac)
LU	Limited Use
MDR1	Medium Density Residential 1 (12-15 du/ac)
MDR2	Medium Density Residential 2 (15-20 du/ac)
MHDR	Medium High Density Residential (20-30 du/ac)
MU1	Mixed Use 1
MU3	Mixed Use 3
NC	Neighborhood Commercial
OP	Office Professional
OS	Open Space
P	Parks
PI	Public/Institutional
RR	Rural Residential (1-2 du/ac)
SH	Senior Housing
SPA	Specific Plan Area
VLDR	Very Low Density Residential (2-4 du/ac)